



COOPLOK™ Grooved Submittal
Fig. 65HP-ES High Pressure Rigid Coupling with End Shield™ Gasket
<p>Figure 65HP-ES couplings with End Shield™ gaskets are designed for use in high pressure piping systems with working pressure ratings up to 2,500 psi.* Working Pressure and End Load values are based on “End Shield” cut or roll grooved extra heavy steel pipe.</p> <p>* Refer to cut sheet for details.</p>

Material Specifications

Housing:

Ductile Iron Housings conform to ASTM A-536, Grade 65-45-12

Coating:

- Black Paint (rust inhibiting) – Standard Coating

Coupling Gasket Style:

- “End Shield” Style – T-Nitrile

Nuts and Bolts:

Zinc electroplated, heat treated, oval neck track head bolts conforming to ASTM-183 Grade 2 with a minimum tensile strength of 110,000 psi; Heavy hex nuts made of carbon steel conforming to ASTM A-563 Grade A or Grade B, or J995 Grade 2.

SCI track bolts are 100% magnetic particle inspected. The SCI logo appears on all COOPLOK™ track bolts.

Coupling Gasket Material:

- Grade T-Nitrile (Orange Stripe)
-20°F (-29°C) to +180°F (+82°C) Service Temperature Range
For use with petroleum applications, vegetable & mineral oils, and air with oil vapors.
NOT FOR USE IN HOT WATER, STEAM, OR NATURAL GAS APPLICATIONS.

Project Information	
Project/Job/System:	
Submittal Date:	
Engineer:	Contractor:
Address:	Address:
City/State:	City/State:
Notes:	

Approval Stamp



Fig. 65HP-ES
High Pressure Coupling with
End Shield™ Gasket

- Maximum working pressure up to 2500 psi depending on coupling size and schedule of pipe
 - All housings, gaskets and bolts identified by SCI logo
 - 100% magnetic particle inspection of each bolt
 - Each bolt has a Minimum tensile strength of 110,000 psi
 - Gasket Grade T - Nitrile (orange stripe) -20°F (-29°C) to +180°F (+82°C)
 - Ductile iron housings conform to ASTM A-536 Grade 65-45-12
 - May only be used with pipe grooves that match ES Groove specifications.
 - Finish: Black Enamel Paint
 - Smith-Cooper Warranty only applies to assemblies made with housings, gaskets and bolts carrying the  logo
 - **Extra Heavy “ES” End Shield™ fittings are available (fabricated steel); Schedule 80, cut grooved**
- Contact Smith-Cooper International for fitting types and sizes.

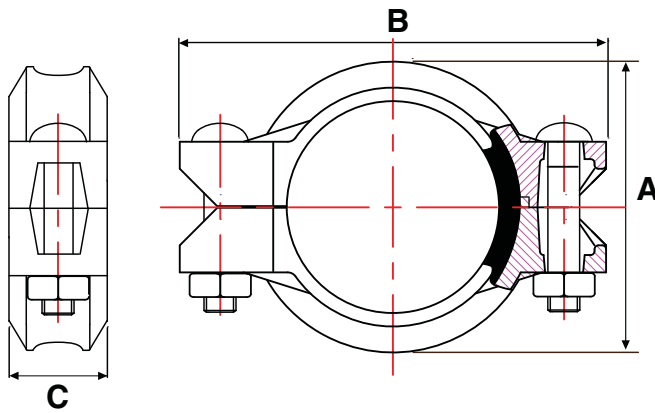

End Shield™ Gasket – Nitrile

Pipe Size in / mm	Part Number	Pipe OD in / mm	Max Pipe End Gap in / mm	Dimensions			Max Working Pressure* psi / kPa	Max End Load* lb / kg	Case Qty	Weight lb / kg
	Painted			A	B	C				
2 50	65HPES3020	2.375 60.3	3/16 4.8	3.50 89.0	5.63 143.0	1.89 48.0	2500 17250	7350 3340	15	3.3 1.5
3 80	65HPES3030	3.500 88.9	3/16 4.8	4.69 119.0	7.01 178.0	1.89 48.0	2500 17250	16500 7500	12	4.3 1.9
4 100	65HPES3040	4.500 114.3	3/16 4.8	5.94 151.0	8.70 221.0	2.13 54.0	2500 17250	28700 13000	6	7.9 3.6
6 150	65HPES3060	6.625 168.3	1/4 6.7	8.31 211.0	11.34 288.0	2.28 58.0	2000 13800	63100 28600	—	14.8 6.7

* Maximum working pressure and maximum end load are determined from all internal and external loads, based on standard weight steel pipe, grooved per Smith-Cooper International (SCI) End Shield™ (ES) Cut Groove Specifications.

NOTE:

65HP-ES couplings are not designed for, and cannot be used with, COOPLOK™ Grooved fittings or 67 Series Grooved Butterfly Valves. Refer to End Shield™ (ES) Cut Groove Specifications.