



COOPLOK™ Grooved Submittal

**Fig. 65LR & 66LR
Lightweight Rigid Couplings**

Figure 65LR & 66LR Lightweight Rigid couplings are designed for use in piping systems when rigid piping connections are desired. The angle-pad design allows the coupling housing to slide when tightened. This provides offset clamping that creates a rigid joint resistant to flexural and torsional loads.



Material Specifications

Housing:

Ductile Iron Housings conform to ASTM A-536, Grade 65-45-12

Coating:

- Orange Paint (Rust inhibiting) - Standard Coating – Fig 65LR
- Hot Dipped Galvanized conforming to ASTM A-153 – Fig 66LR

Coupling Gaskets:

- Pre-lubricated Grade E-EPDM (Green Stripe)
-30°F (-34°C) to +230°F (+110°C) Service Temperature Range
For use with water service, diluted acids, alkali solutions, oil-free air and other chemical services. NOT FOR PETROLEUM, STEAM, or NATURAL GAS APPLICATIONS.
- Grade T-Nitrile (Orange Stripe)
-20°F (-29°C) to +180°F (+82°C) Service Temperature Range
For use with petroleum applications, vegetable & mineral oils, and air with oil vapors. NOT FOR USE IN HOT WATER, STEAM, or NATURAL GAS APPLICATIONS.
- Other: _____

Nuts and Bolts:

Zinc electroplated, heat treated, oval neck track head bolts conforming to ASTM 183 Grade 2 with a minimum tensile strength of 110,000psi; Heavy hex nuts made of carbon steel conforming to ASTM A-563 Grade A or Grade B, or J995 Grade 2.

SCI Track Bolts are 100% Magnetic Particle Inspected
The SCI logo appears on all COOPLOK™ track bolts.

Project Information	
Project /Job:	System:
Date:	
Engineer/Architect:	
Contractor:	
Address:	
Notes:	



500 Series Lightweight Rigid Couplings

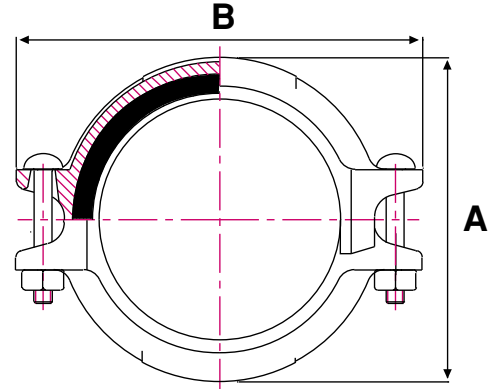
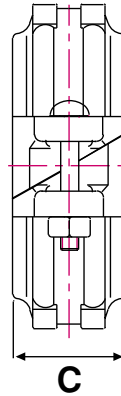

Fig. 65LR & 66LR – Lightweight Rigid Couplings

Part Number		Pipe Size IN / mm	Pipe OD IN / mm	Max Pipe End Gap IN / mm	Max End Load LB / kg	Max Working Pressure PSI / bar	Dimensions			Bolt Size IN / mm	Weight LB / kg
Painted	Galv						A IN / mm	B IN / mm	C IN / mm		
65LR3012	66LR3012	1-1/4	1.660	1/8	1,082	500	2.66	4.09	1.85	3/8" x 2	1.2
		32	42.2	3.2	491	34.5	67.6	103.9	47.0	M10 x 52	0.5
65LR3014	66LR3014	1-1/2	1.900	1/8	1,418	500	2.93	4.37	1.85	3/8" x 2	1.3
		40	48.3	3.2	643	34.5	74.4	111.0	47.0	M10 x 52	0.6
65LR3020	66LR3020	2	2.375	1/8	2,215	500	3.44	4.8	1.85	3/8" x 2-1/2	1.7
		50	60.3	3.2	1,005	34.5	87.4	121.9	47.0	M10 x 60	0.8
65LR3024	66LR3024	2-1/2	2.875	1/8	3,246	500	3.96	5.28	1.85	3/8" x 2-3/4	1.9
		65	73.0	3.2	1,472	34.5	100.6	134.1	47.0	M10 x 65	0.9
65LR3030	66LR3030	3	3.500	1/8	4,811	500	4.55	5.91	1.85	3/8" x 2-3/4	2.1
		80	88.9	3.2	2,182	34.5	115.6	150.1	47.0	M10 x 65	0.9
65LR3040	66LR3040	4	4.500	1/4	7,952	500	5.83	7.28	2.01	3/8" x 2-3/4	3.6
		100	114.3	6.4	3,606	34.5	148.1	184.9	51.1	M10 x 65	1.6
65LR3050	66LR3050	5	5.563	1/4	12,153	500	6.87	8.62	2.01	1/2" x 3-3/4	5.1
		125	141.3	6.4	5,511	34.5	174.5	218.9	51.1	M12 x 95	2.3
65LR3060	66LR3060	6	6.625	1/4	17,236	500	8.03	9.76	2.01	1/2" x 3-1/4	6
		150	168.3	6.4	7,816	34.5	204.0	247.9	51.1	M12 x 95	2.7
65LR3080	66LR3080	8	8.625	1/4	29,213	500	10.16	12.52	2.52	5/8" x 4-1/2	10.6
		200	219.1	6.4	13,248	34.5	258.1	318.0	64.0	M16 x 120	4.8

NOTES:

1. All bolts and gaskets identified by SCI logo.
2. 100% Magnetic particle inspection of each bolt. Each bolt has a minimum tensile strength of 110,000 psi.
3. Gaskets are pre-lubricated.
4. Gasket Grade E EPDM (green stripe):
 - Temperature range: -30°F (-34°C) to +230°F (+110°C).
5. Gasket Grade T Nitrile (orange stripe):
 - Temperature range: -20°F (-29°C) to +180°F (+82°C).
7. SMITH-COOPER Warranty only applies to assemblies made up using gaskets, housings, and bolts with the logo.

Torque Requirements for Bolts (ft./lbs)	
Coupling Size	Fig. 65LR & Fig. 66LR
1-1/4" - 1-1/2"	30
2" - 2-1/2"	30
3" - 4"	30
5" - 6"	50
8"	90

30 ft./lbs. = 40 N/M
50 ft./lbs. = 67 N/M
90 ft./lbs. = 121 N/M
150 ft./lbs. = 202 N/M

